

NOTES:
 ALL DIMENSIONS TO BE CHECKED AND CONFIRMED ON SITE PRIOR TO ANY WORKS OR FABRICATION.
 DO NOT SCALE OFF THIS DRAWING.
 ANY ERRORS, OMISSIONS OR DISCREPANCIES ARE TO BE BROUGHT TO THE ATTENTION OF MUNRO ASSOCIATES IMMEDIATELY.

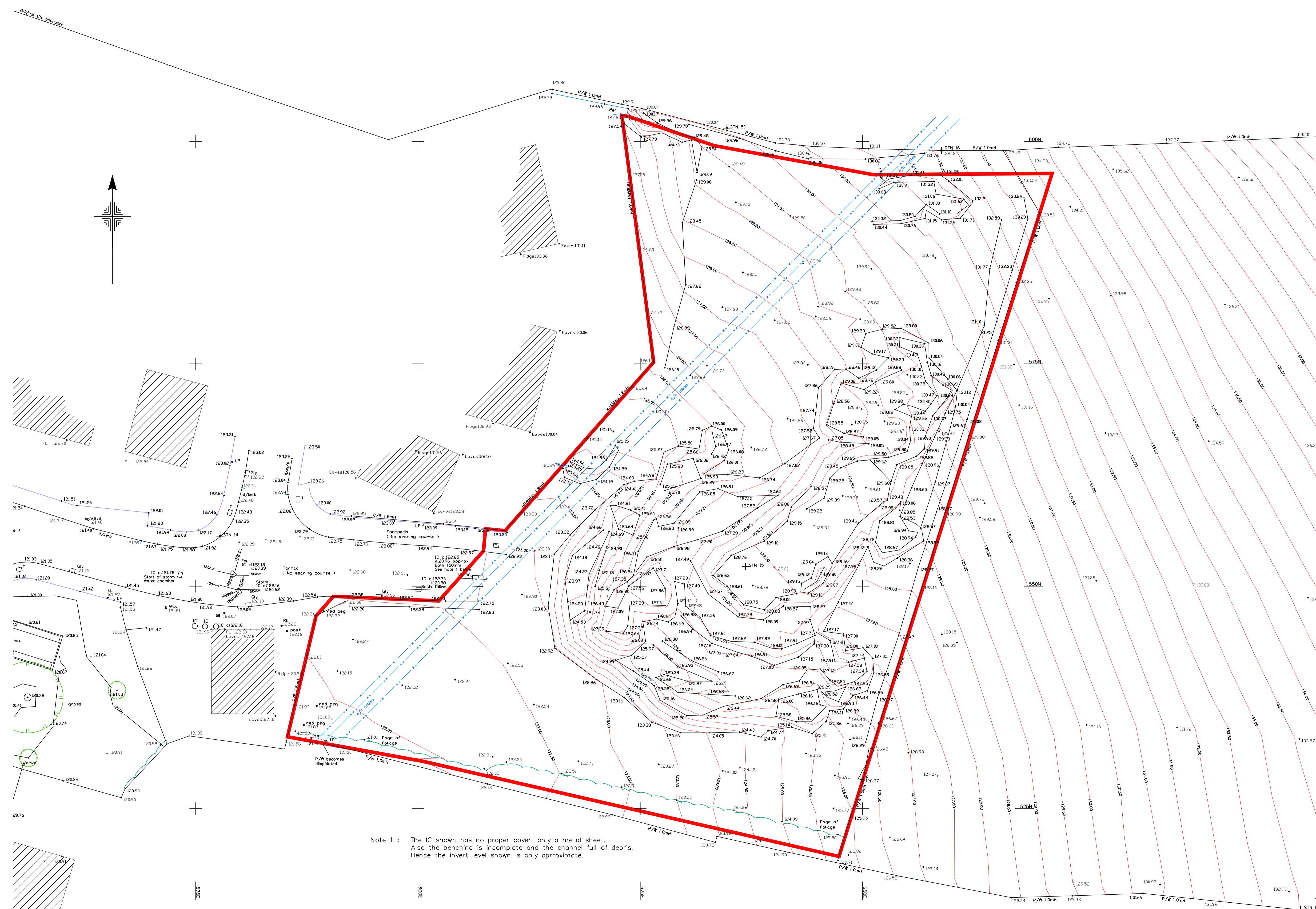

Note 1 :- The IC shown has no proper cover, only a metal sheet.
 Also the benching is incomplete and the channel full of debris.
 Hence the invert level shown is only approximate.

| REV | DATE | DESCRIPTION | BY |
|-----|----------|---------------------|----|
| A | 14-03-18 | Site boundary added | PO |

Drawing Status
FOR INFORMATION



www.munro-associates.com
 CHARLTON HOUSE, DRAYTONS PASSAGE, SHROPSHIRE, SY11 1HF
 T: 01743 341438 E: design@munro-associates.com
 CRANHAMOR, 6 CROFTCROFT, CROFTINGHAM, WILTSHIRE, SN11 5DG
 T: 01794 473234 F: 01794 473234 E: design@munro-associates.com

Client: Mid Wales Housing Association
 Project: Proposed Residential Development Site Adjacent to Maes Y Dderwen Llanfyllin Powys

Scale: 1:200 @ A1
 Date: August 2017
 Drawn: -

Drawing Title
EXISTING SITE PLAN

| Project No. | Drawing No. | Revision |
|-------------|-------------|----------|
| 16.119 | 002 | A |

© THE CONTENTS OF THIS DRAWING ARE THE COPYRIGHT OF MUNRO ASSOCIATES. IT MUST NOT BE REPRODUCED NOR AMENDED BY A THIRD PARTY WITHOUT OUR WRITTEN PERMISSION.

Munro Associates (Architectural Services) Limited
 Registered Office: Charlton House, Draytons Passage, Shoplatch, Shrewsbury, Shropshire, SY11 1HF.
 Registered in England and Wales
 Registration No. 08117820 Vat No. 650 8829 15